

# OIL-LESS RISER MOUNTED AIR COMPRESSOR



General Air's oil less riser mounted air compressors are fully automatic, virtually maintenance free and are designed to be easily installed on the riser, wall or floor.

## Technical Info

Part #	6520343
System Capacity (gallons)	500
Average CFM	6.06
Motor HP	3/4
Phase	Single
Available Voltages	115v, 208-230v
Recommended Accessories	Motor Line Starter



This oil less riser mounted air compressor is UL1450 listed for use in sprinkler systems.

## System Layout

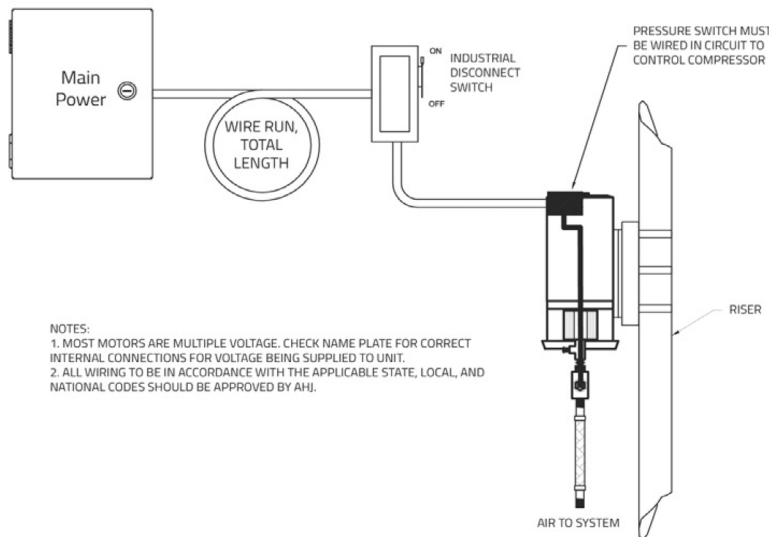

NOTES:  
 1. MOST MOTORS ARE MULTIPLE VOLTAGE. CHECK NAME PLATE FOR CORRECT INTERNAL CONNECTIONS FOR VOLTAGE BEING SUPPLIED TO UNIT.  
 2. ALL WIRING TO BE IN ACCORDANCE WITH THE APPLICABLE STATE, LOCAL, AND NATIONAL CODES SHOULD BE APPROVED BY AHJ.

## Pressure Switch Connection

### PRESSURE SWITCH Diagram

Note: Location of pressure switch varies based on model. This is a general diagram of components. For help specific to your switch please contact General Air products.

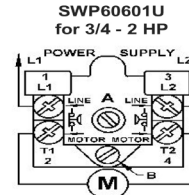
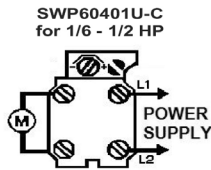

### Warning:

Failure to consult with a licensed electrical professional can result in serious personal injury or death. Disconnect all power before servicing. Undersized wire between the motor and the power source will limit the starting and load carrying abilities of the motor causing motor overheating and permanent damage to the motor. Wire sizes listed are recommendations only. Consult the National Electric Code (NEC) and any applicable local electrical safety codes. The NEC and GAP recommends a maximum voltage drop of 3%. Install motors and related equipment in accordance with the National Electrical Code (NEC) local electrical safety codes and practices. **It is always the electrician's responsibility to determine and install a wire size that ensures motors can start and run well.**

System No.		Location		Spec Section		Paragraph	
Submitted By		Date		Approved		Date	